



Policy 5474:

The following policy establishes lot sizes in Sections 21-4-7 & 22-4-7, in the area generally bounded by Blundell Road, No. 1 Road, Francis Road, and West Dyke Trail as shown on the attached map:

1. That properties within the area generally bounded by Blundell Road, No. 1 Road, Francis Road, and West Dyke Trail in Section 21-4-7 & 22-4-7, as shown on the attached map, be permitted to subdivide in accordance with the provisions of Single-Family Housing District, Subdivision Area E (R1/E) in Zoning and Development Bylaw No. 5300 with the following exceptions:

That lots with existing duplexes be permitted to rezone and subdivide into two (2) equal halves lots;

and that this policy be used to determine the disposition of future single-family rezoning applications in this area, for a period of not less than five years, unless amended according to Zoning and Development Bylaw No. 5300.

2. Multiple-family residential development shall not be permitted.

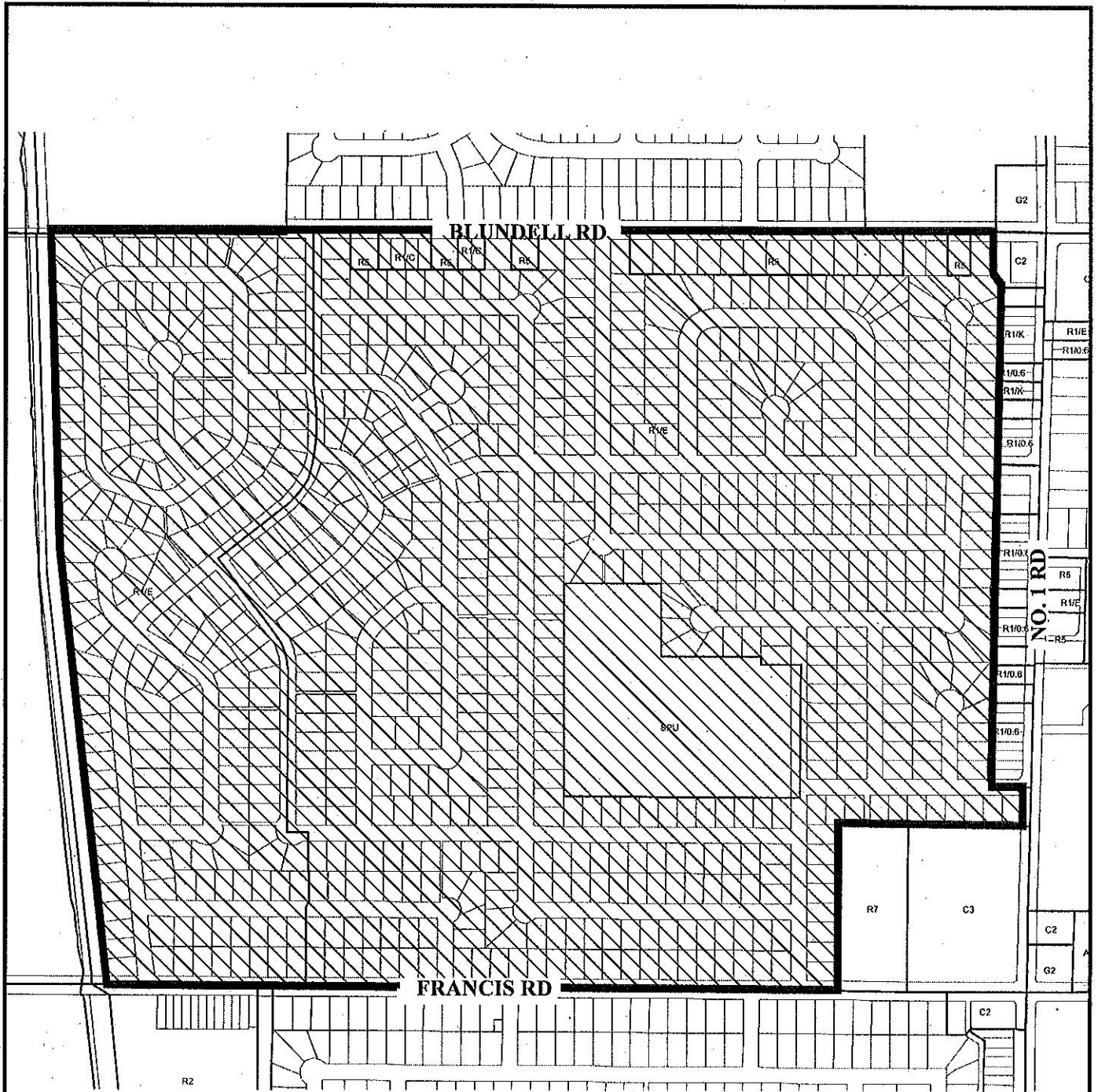

 Subdivision permitted as per R1/E



Policy 5474
21-4-7 & 22-4-7

Original Date: 02/29/08

Amended Date: 05/20/08

Note: Dimensions are in METRES